

# Diplomat Electric

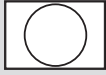

## Available Screen Materials



**Arctiq**  
The screen fabric has a matt white surface.



**GreyLight** (gain 0.93)  
The screen fabric has a high contrast matt grey surface.



**FlexRear**  
Grey rear projection diffusing surface. Provides high resolution and excellent contrast.



**Acoustic**  
White sound transparent material which provides 180° viewing angle.

## Available Formats



**H>W NORDIC**  
Nordic Format, height>width, with extra height that gives additional flexibility. No black borders.

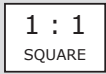

**1 : 1 SQUARE**  
The screen format is 1:1. No black borders.



**4 : 3 VIDEO**  
The screen has 5 cm wide black borders. The format of the viewing area is 4:3.



**16 : 10 DATA**  
The screen has 5 cm wide black borders. The format of the viewing area is 16:10.

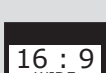

**16 : 9 WIDE**  
The screen has 5 cm wide black borders. The format of the viewing area is 16:9.



**2.35 : 1 CINEMASCOPE**  
The screen has 5 cm wide black borders. The format of the viewing area is 2.35:1.

## Control Options

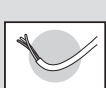

**Installation**  
5m cable. Needs to be installed by electrician.



**Switch**  
The screen is operated by a 3-positions in-line switch.



**Remote Control**  
The screen is operated by a 3-positions IR remote control.



**AutoLink**  
The screen goes automatically down/up when turning the projector on/off.

Diplomat Electric is a high quality screen which, thanks to the robust construction and flexible installation, is the preferred screen among our professional buyers. The installation is very flexible with mounting brackets that can be adjusted side-ways to preferred positions. The screen can be mounted on the wall as well as in the ceiling. It comes in a white painted aluminium case and can be operated by an in-line switch, an IR remote control or automatically by an AutoLink connected to the projector. For system installations it's also available with cable only. All control options are easily connected to the screen via the universal connector on the screens backside.

## Screen Dimensions

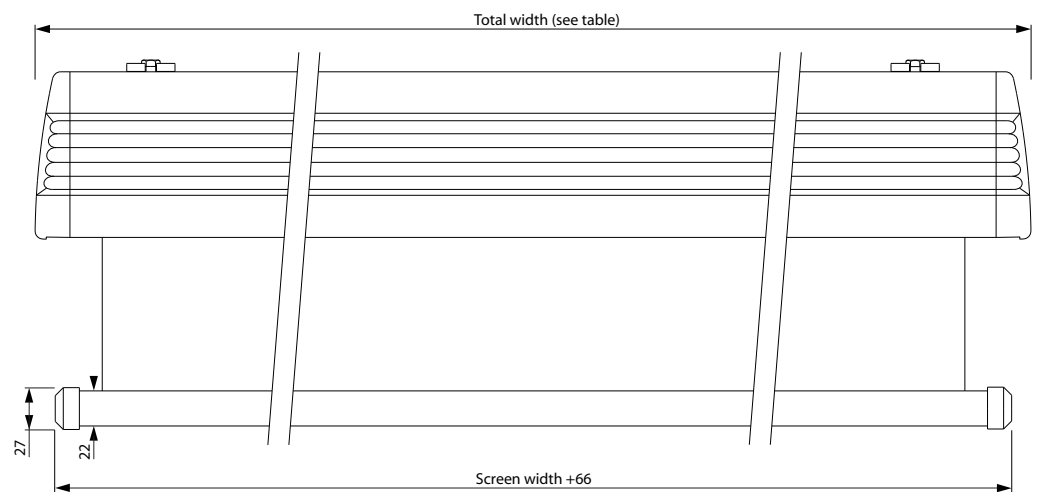

Screen width	Total width
1250 - 2000	Screen width +86
2200 - 3000	Screen width +94

### Example – Diplomat Electric Dimensions

Model: MD2724  
Screen width: 2700 mm  
Total width: 2700 mm + 94 mm = 2794 mm  
Bar width: 2700 mm + 66 mm = 2766 mm

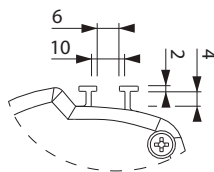
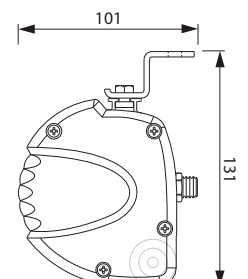
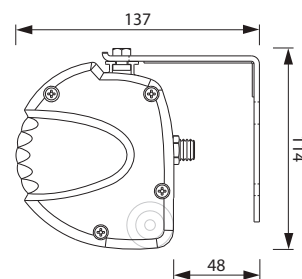
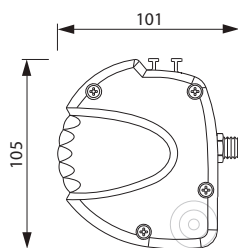

All dimensions in this document are in mm

Document PDSMD ver 1.1, page 1 of 3



Bjurab Sweden AB  
Kristinebergsvägen 22  
SE-302 41 Halmstad  
Sweden

Tel: +46 – 35 – 144290  
Fax: +46 – 35 – 144291  
Email: info@bjurab.se  
Web: www.bjurab.se

## Bracket Dimensions

### Brackets – Wall

Included in all Diplomat products

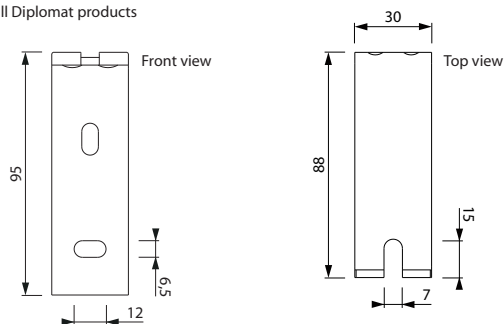

### Brackets – Ceiling

Included in all Diplomat products

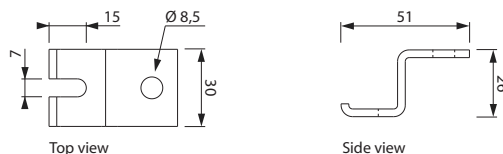

## Packaging Dimensions

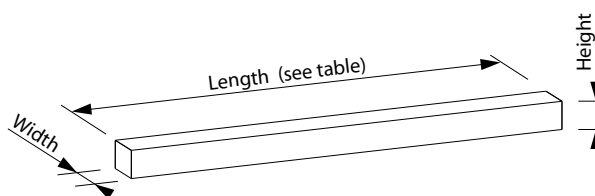

Screen width	Box length	Box width	Box height
1250 - 1600	1820	150	125
1800	2020	150	125
2000	2570	150	125
2200	2770	120	120
2400	2970	120	120
2700	3270	120	120
3000	3540	120	120



### Switch

Enclosed with the screen, when ordered.

Weight – 0.32kg



### Installation

Enclosed with the screen, when ordered.

Weight – 0.40kg

### Remote Control

Delivered separately



Art. no euro plug: 210695  
UK plug: 210695-UK

Communication – Infrared  
Batteries handcontrol – 2pcs 1,5 volt AAA, included  
Dim. & weights – Handcontrol: 162 x 50 x 28 (0.085kg)  
Receiver: 120 x 72 x 35 (0.42kg)  
Package: 710 x 105 x 56  
Weight all together – 0.64kg

### AutoLink

Delivered separately

Art. no euro plug: 210700  
UK plug: 210700-UK

Communication – Infrared  
Dim. & weights – Receiver: 120 x 72 x 35 (0.42kg)  
Transmitter: 103 x 57 x 36 (0.26kg)  
Package: 710 x 105 x 56

Weight all together – 0.87kg

### Switch

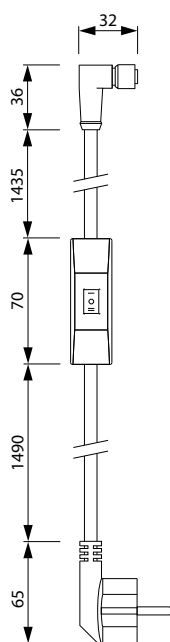

### Installation

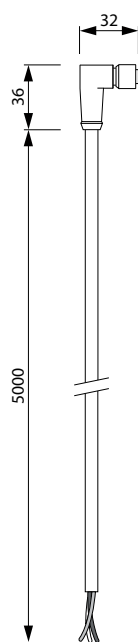

### Receiver

part of Remote Control as well as AutoLink

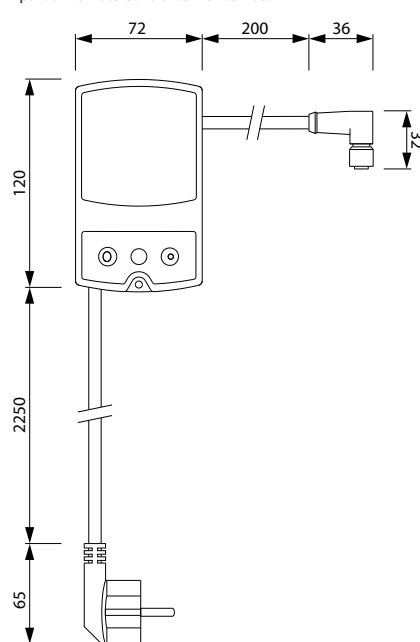

### Transmitter

part of AutoLink

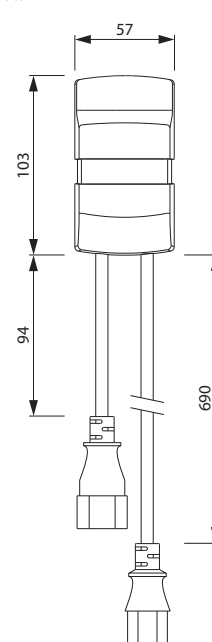

All dimensions in this document are in mm.

Document PDSMD ver 1.1, page 2 of 3



Bjurab Sweden AB  
Kristinebergsvägen 22  
SE-302 41 Halmstad  
Sweden

Tel: +46 – 35 – 144290  
Fax: +46 – 35 – 144291

Email: info@bjurab.se  
Web: www.bjurab.se

# Electrical specifications

## Plug options



Motorized screens, except Installation version, are delivered with either Euro plug or UK plug (both grounded).

## Motor Specifications

Voltage: 220 V      Frequency: 50 Hz  
Power: 85 W      Momentum: 6Nm  
Speed: 28 rpm      Protection: IP44

The motor is grounded

## Cable Specifications

Thickness: Ø 7 mm  
Cable area: 4x0,34mm<sup>2</sup>, motor to control  
3x0,34mm<sup>2</sup>, control to plug  
Wires: Black - Up, Brown - Down  
Blue - Neutral  
Green/Yellow - Ground

# Article Numbers for Diplomat Electric

## Nordic Format, H > W

ART. NO	SCREEN SIZE WIDTH x HEIGHT	WT. KG
MD1420	1400 x 2000	6.3
MD1520	1500 x 2000	6.8
MD1620	1600 x 2000	8.1
MD1820	1800 x 2000	8.9

## Other Formats

MD2724	2700 x 2250	16.2
MD3024	3000 x 2250	17.2

## Square Format, 1 : 1

ART. NO	SCREEN SIZE WIDTH x HEIGHT	WT. KG
MD125	1250 x 1250	5.0
MD150	1500 x 1500	6.5
MD180	1800 x 1800	9.0
MD200	2000 x 2000	11.1
MD220	2200 x 2200	12.8
MD240	2400 x 2400	14.2
MD270	2700 x 2700	16.6
MD300	3000 x 3000	18.2

## Video Format, 4 : 3

ART. NO	SCREEN SIZE WIDTH x HEIGHT	VIEW. AREA WIDTH x HEIGHT	WT. KG
MD1617-V	1600 x 1850	1500 x 1125	8.4
MD1817-V	1800 x 1850	1700 x 1275	9.9
MD2017-V	2000 x 1850	1900 x 1425	11.4
MD2217-V	2200 x 1800	2100 x 1575	12.6
MD2420-V	2400 x 2050	2300 x 1725	14.0
MD2724-V	2700 x 2250	2600 x 1950	16.2
MD3024-V	3000 x 2350	2900 x 2175	17.7

## Wide Format, 16 : 9

ART. NO	SCREEN SIZE WIDTH x HEIGHT	VIEW. AREA WIDTH x HEIGHT	WT. KG
MD1617-W	1600 x 1850	1500 x 845	8.4
MD1817-W	1800 x 1850	1700 x 955	9.9
MD2017-W	2000 x 1850	1900 x 1070	11.4
MD2217-W	2200 x 1800	2100 x 1180	12.6
MD2417-W	2400 x 1800	2300 x 1295	13.4
MD2724-W	2700 x 2050	2600 x 1460	15.7
MD3024-W	3000 x 2050	2900 x 1630	17.2

All weights are gross (total weight including packaging, brackets etc.).

Standard screen material is white. Screens with Greylight, Greyline, ReAct, Rear Projection and Acoustic fabric are available in sizes with maximum height of 2400 mm.

For article numbers with Greylight replace MD by MG. Example: An 2217-W with Greylight fabric = MG2217-W

For article numbers with Greyline replace MD by MGL. Example: An 2217-W with Greyline fabric = MGL2217-W

For article numbers with ReAct replace MD by MDS. Example: An 2217-W with ReAct fabric = MDS2217-W

For article numbers with Rear Projection replace MD by MDR. Example: An 200 with Rear Projection fabric = MDR200

For article numbers with Acoustic replace MD by MA. Example: An 2217-W with Acoustic fabric = MA2217-W

The first part of the article number indicates the control option; MD = Switch and MDI = Installation. Example: An 1817-V with ReAct fabric for Installation = MDSI1817-V

Inline Switch is supplied with euro plug as standard. For UK plug add -UK at the end of the article number. Example: An 1817-V with ReAct fabric and UK plug = MDS1817-V-UK

For article numbers with CinemaScope (2.35:1), please see our pricelist.

# Accessories

## ARTICLE NO

485030	30 cm brackets, pair
485050	50 cm brackets, pair
485075	75 cm brackets, pair

## ARTICLE NO

210603	Switch, 2-positions
210660	RF-control, 3-positions, euro plug
210660-UK	RF-control, 3-positions, UK plug

## ARTICLE NO

210604	Keypress, 3-positions
400300	Screen Cleaning Spray, 250 ml

